

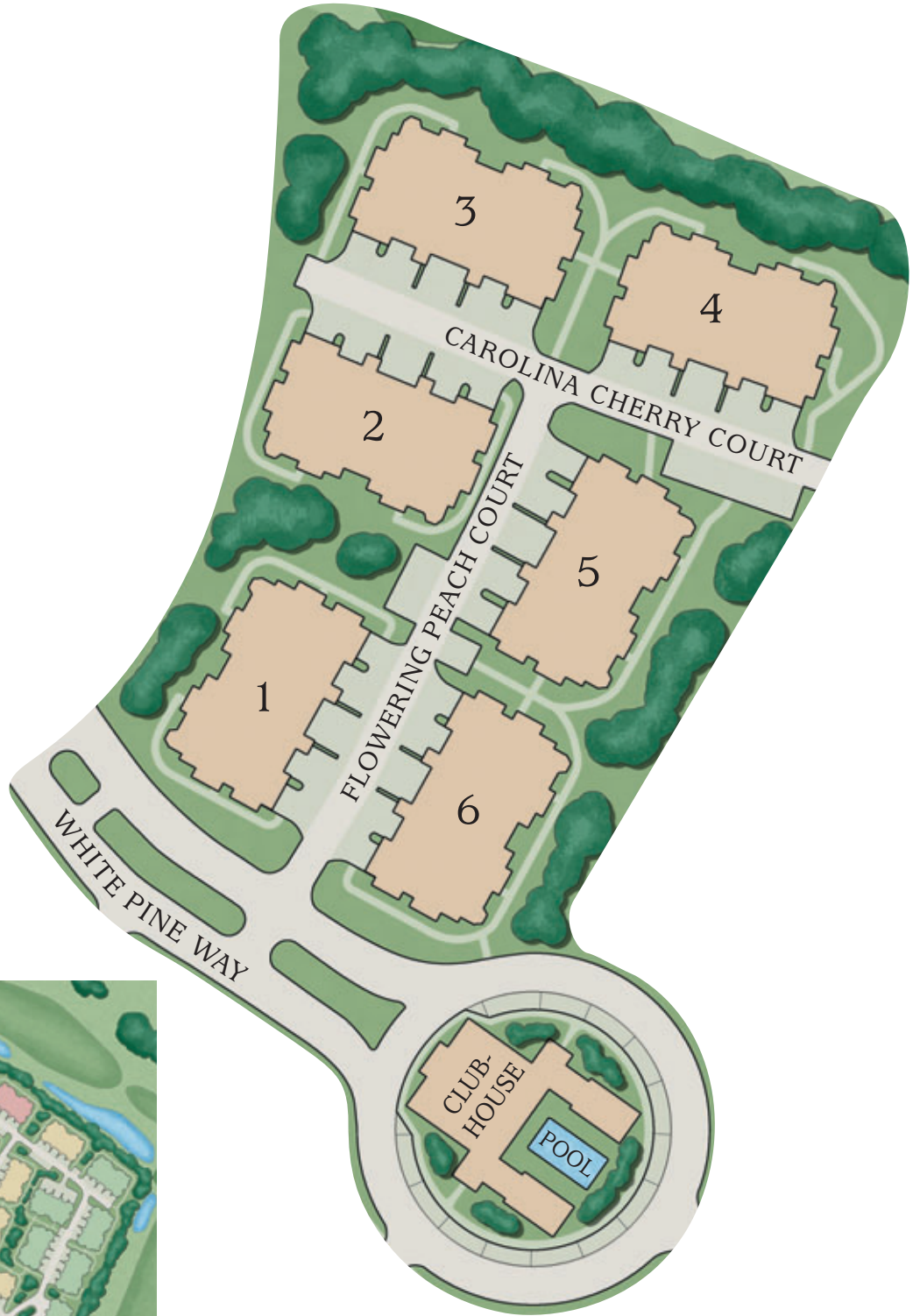

# Middleborough

at Shadowmoss Plantation

## Condominium Phase One



Enlarged Area



This master plan is a concept plan only. The developer of Middleborough Condominiums at Shadowmoss Plantation reserves the right to modify this plan at any time, subject to zoning laws of the City of Charleston. Changes may include, without limitation, adding or deleting property, re-zoning, and modifying density and product. The actual location of the condominium units and other facilities shall be as set forth in the Master Deed to be recorded for each phase, as and when developed. The developer is not obligated to develop all projected phases.